

Fieldwork registration form

Project description:

Date:	Client:	Local authority:	Address:
-------	---------	------------------	----------

Section or row code:

Operator:

Helper(s):

Work method (select multiple options):

- Surface detection Real-time Magnetometer
 Depth detection Non real-time Metal detector
 Other, namely:.....

Brand and type of detecting equipment	
Number and code detecting equipment	
Equipment settings	
Description of weather conditions (Temperature and precipitation)	
Relevant visual observations (Disruptions and details)	
Deviations from project plan (assignment)	
Verification of supplied data (measurement data can be used for interpretation)	
Summary of objects found (number and description):	
Draw the location of the found objects and / or disturbing factors (non-removable) objects in the detailed view of the measuring field on the next page.	

Fieldwork drawing - Surface detection

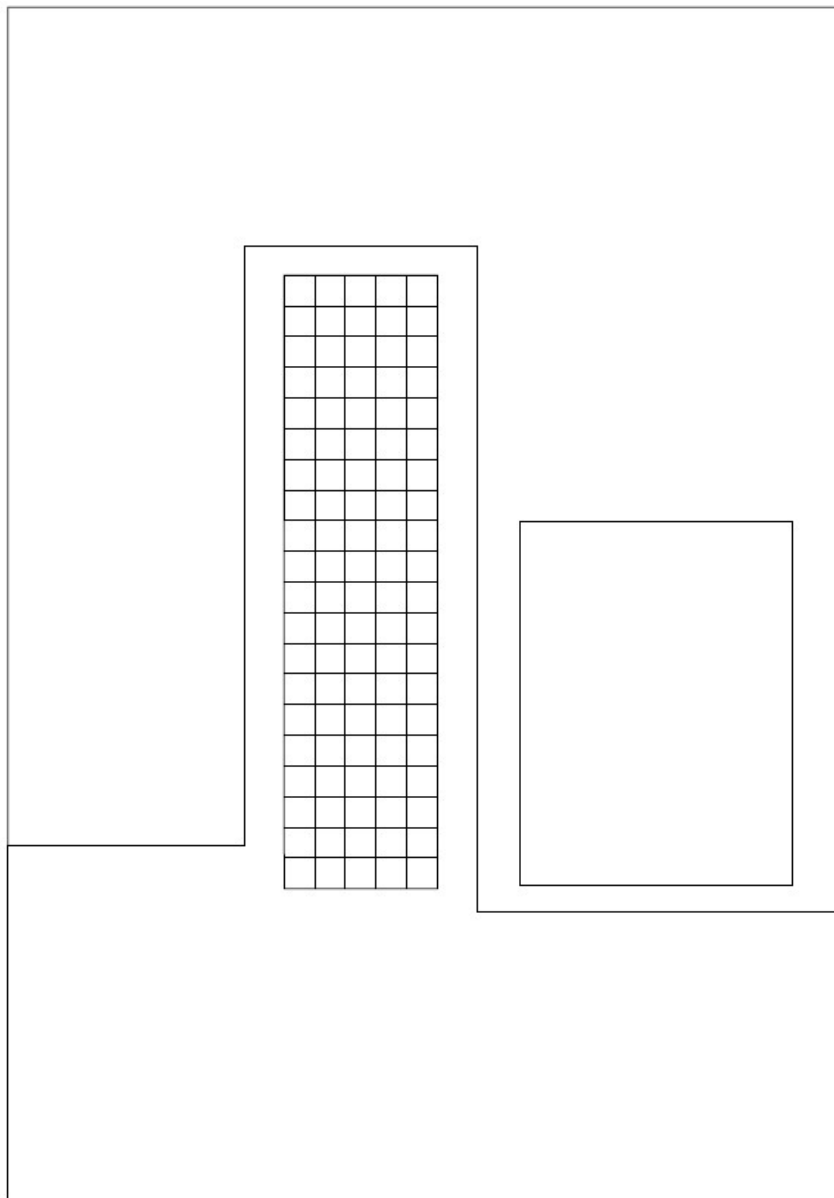

Schematic representation of the detection area for surface detection (A1, A2 and C1) in sections of 1 x 1 meter (5 (X) x 20 (Y) meters).

Object list

Object	X [meters]	Y [meters]	Z [meters]
1			
2			
3			
4			
5			

Fieldwork drawing - Depth detection

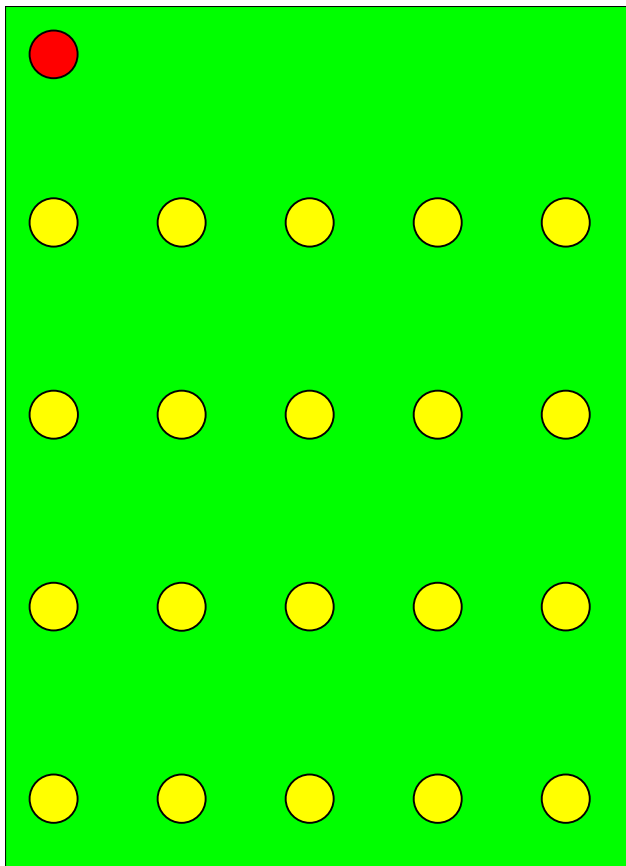

Schematic representation of the measurement field for depth detection (C2).